

## SINGLE WALL UNITS: 300mm - 600mm;

### IMPORTANT INFORMATION- PLEASE READ CAREFULLY

Shown below is a general assembly diagram and a list of fittings. These show the correct number of parts and fittings required to assemble the cabinet. Please note that all parts are identified by a capital letter (eg. A) and fittings are identified by a lower case letter (eg. a). These will be referred to in the following instructions.

The assembly sequence is shown in logical numbered steps.

There may be extra parts and fittings supplied, do not discard these until your kitchen is completed.

The important parts within these steps have been highlighted to help with identification. Unless noted otherwise, assembly is the same for all units.

Note: Doors referred to in these instructions are supplied separately.

Useful tips: Lay large panels on the floor and use the packaging to protect the panels.

Do not overtighten screws. Plumbing, gas and electrical services should be prepared by an approved tradesman before installing the new kitchen.



**CAUTION: SMALL FITTINGS CHOKING HAZARD. KEEP AWAY FROM SMALL CHILDREN.**

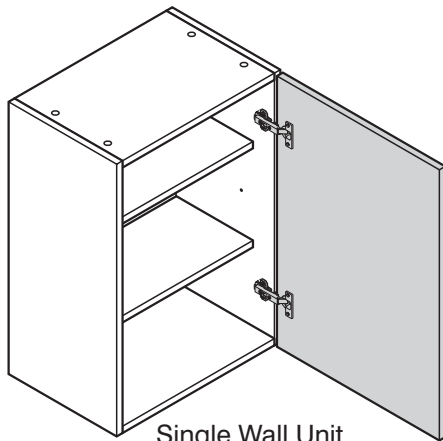

Single Wall Unit  
300mm - 600mm wide

#### COMPONENTS

#### FITTINGS

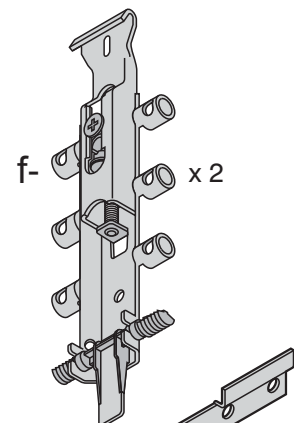
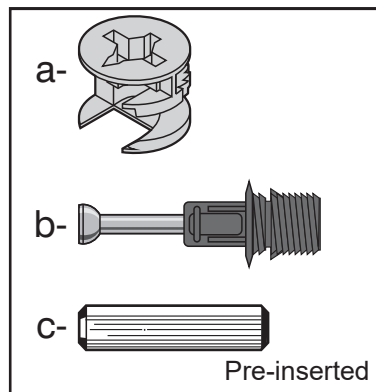
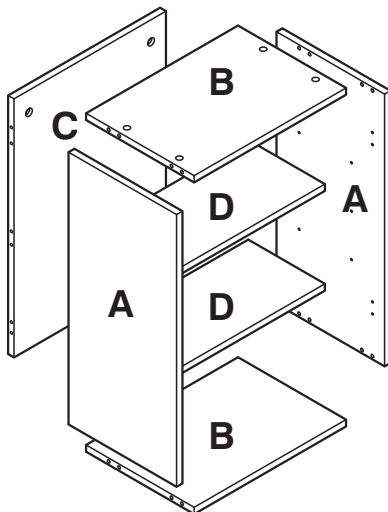

Supplied as one piece and has to be snapped into 2 pieces.



#### TOOLS REQUIRED

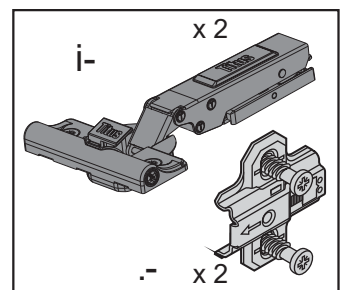
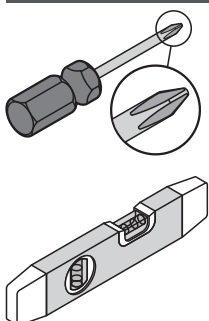

1

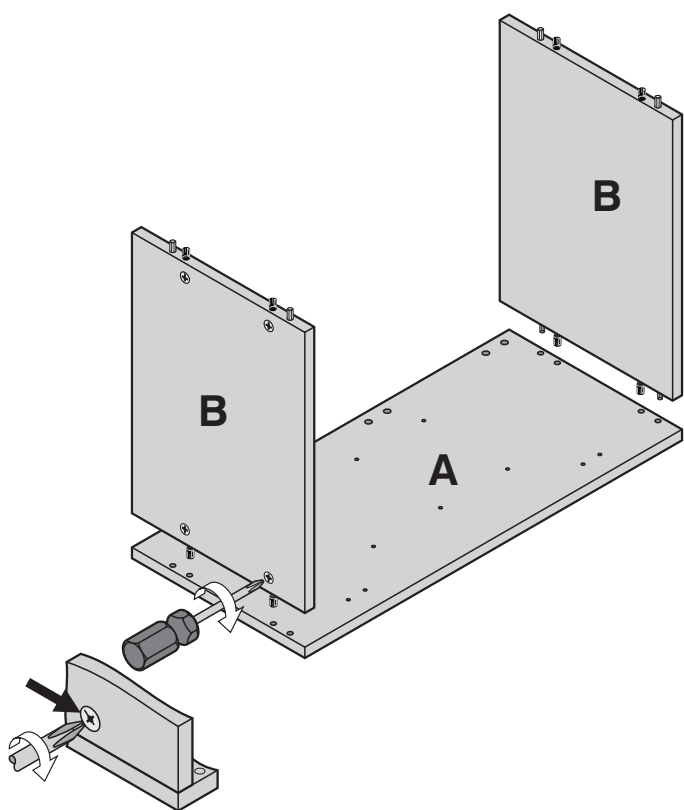

**Important:** Do not overtighten.

2

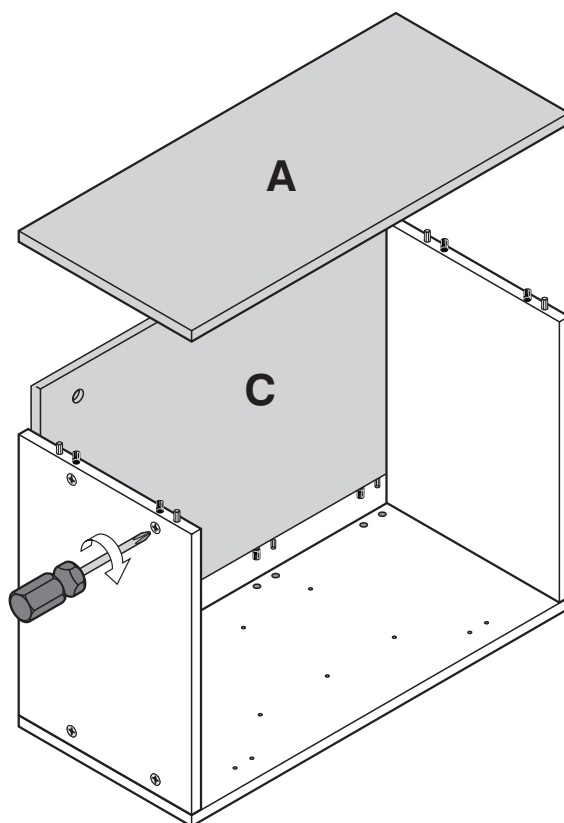

3

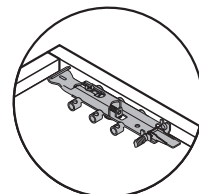
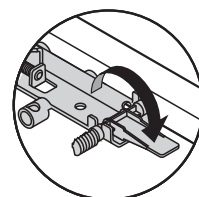
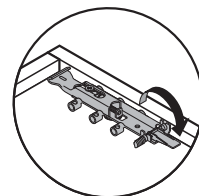
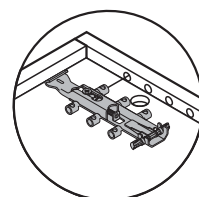
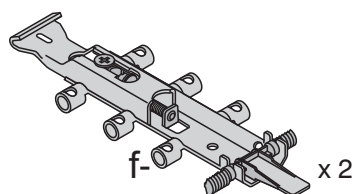
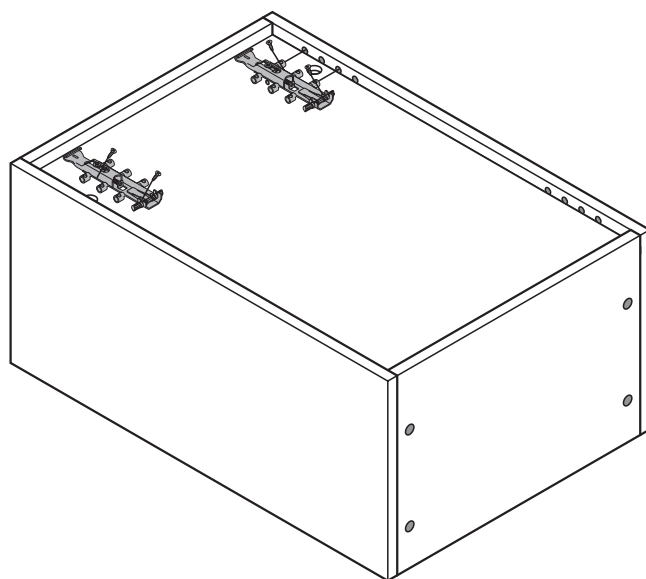

4

**Important:** Please refer to the appliance manufacturer's instructions for information regarding the minimum distance allowed between the appliances and wall units.

Measurement is to the top outer corner of the plate (g). Fasten the wall hanging plates securely to the wall with fixings suitable for the type of wall (not supplied).

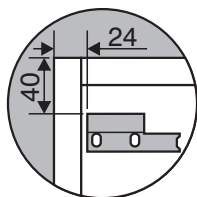

Height of Larder  
or Appliance Units  
(if supplied)

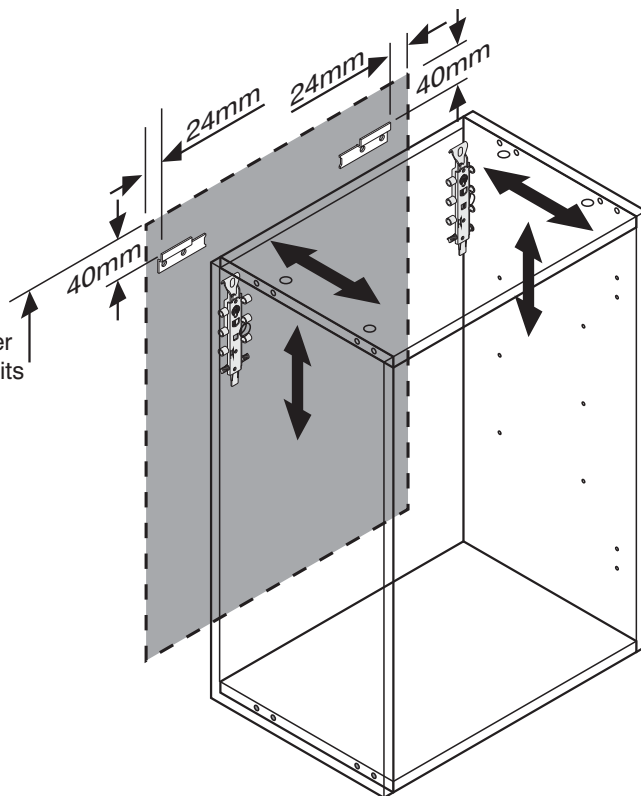

Supplied as one piece  
and has to be snapped  
into 2 pieces.

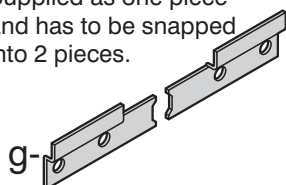

## Levelling

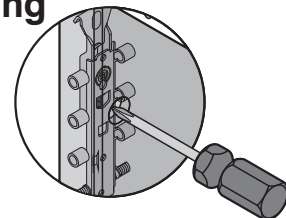

## Vertical

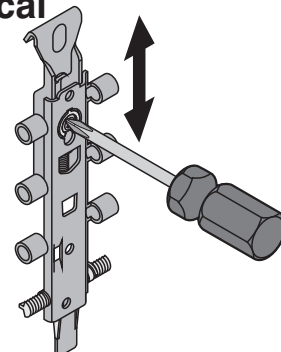

## Horizontal

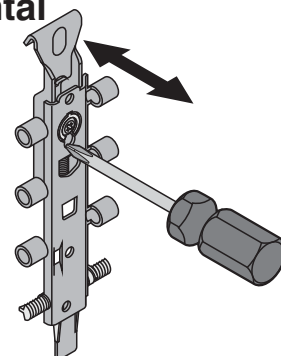

5

